

The square footages and room size information are deemed to be reliable but are not guaranteed and should be independently verified. This drawing is for marketing purposes only.

# 2091 E Sentry Ridge Court

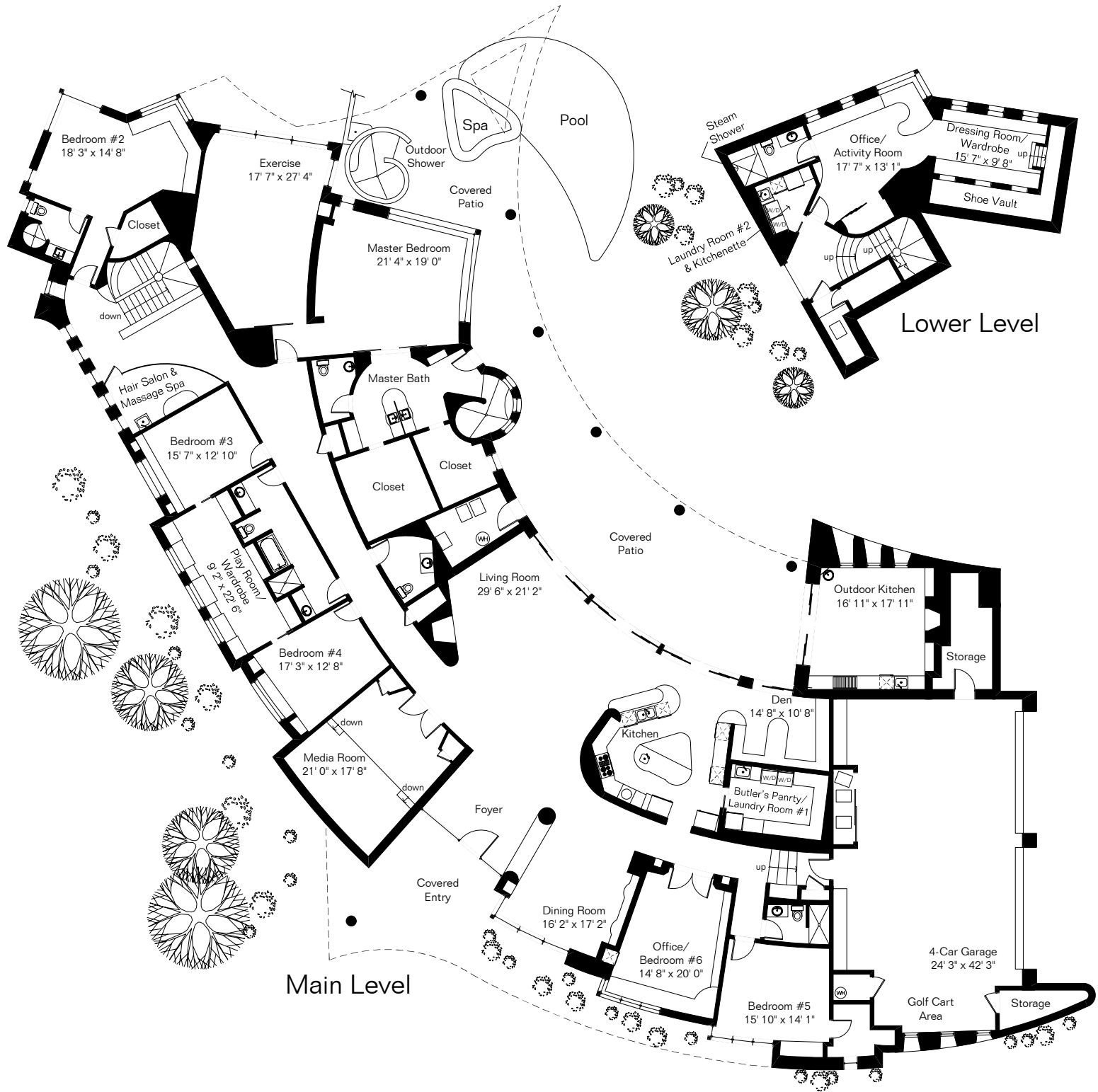

Site Visit May 2019

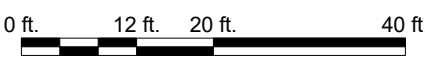

Copyright 2021 Floor Plans First! LLC  
All Rights Reserved.

Living Area 9,825 Sq Ft  
 Covered Entry 676 Sq Ft  
 Covered Patio 1,877 Sq Ft  
 Garage 1,428 Sq Ft  
**Total Under Roof 13,806 Sq Ft**

**Floor Plans First!**  
 See the Floor Plan First!  
 FloorPlansFirst.com  
 (520) 881-1500

The square footages and room size information are deemed to be reliable but are not guaranteed and should be independently verified.

# 2091 E Sentry Ridge Court Greenhouse & Treehouse

Presented by Russell & Christine Long  
Long Realty Company  
(520) 529-1116

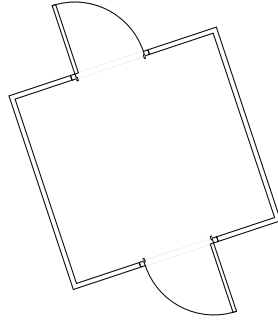

Greenhouse

Firepit

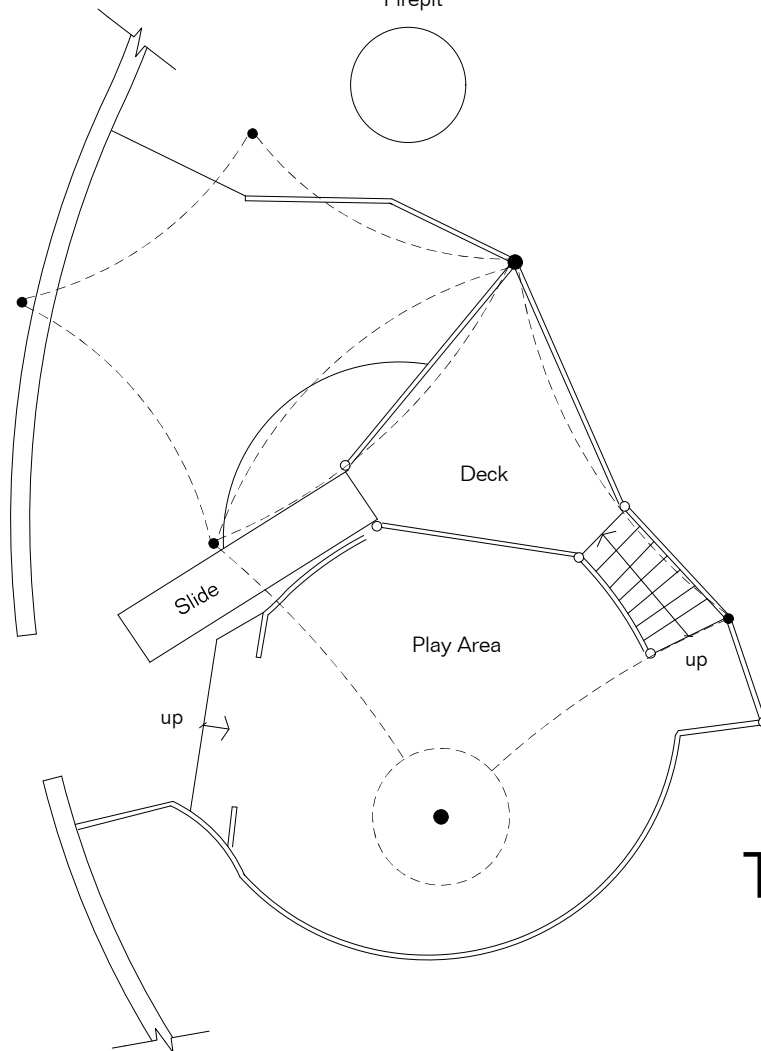
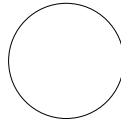

Treehouse

Site Visit May 2019

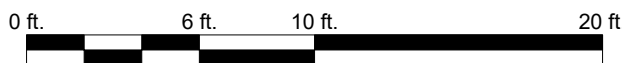

Copyright 2019 Floor Plans First! LLC  
All Rights Reserved.

[www.FloorPlansFirst.com](http://www.FloorPlansFirst.com)

Toll Free (877) 887-1500  
Voice (520) 881-1500

